

TERZANI
LA LUCE PENSATA

Abacus large linear multi light pendant
0V15S-FR4D

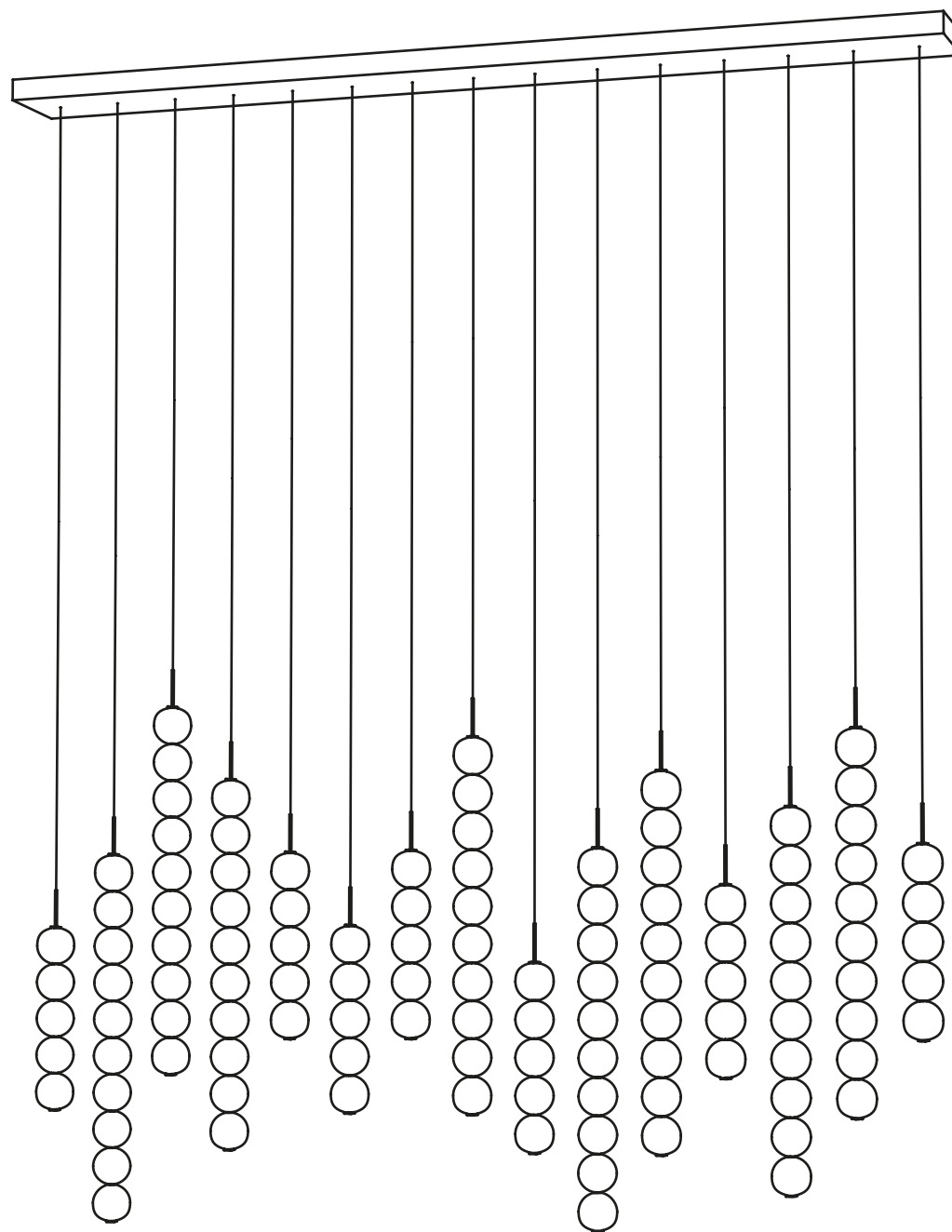



ABACUS

CODE 0V15S -- - FR4D

220-240V ~ 50/60Hz MAX 82,8W

12Vdc 7xMAX 3,6W

12Vdc 8xMAX 7,2W

integrated LED

3000K

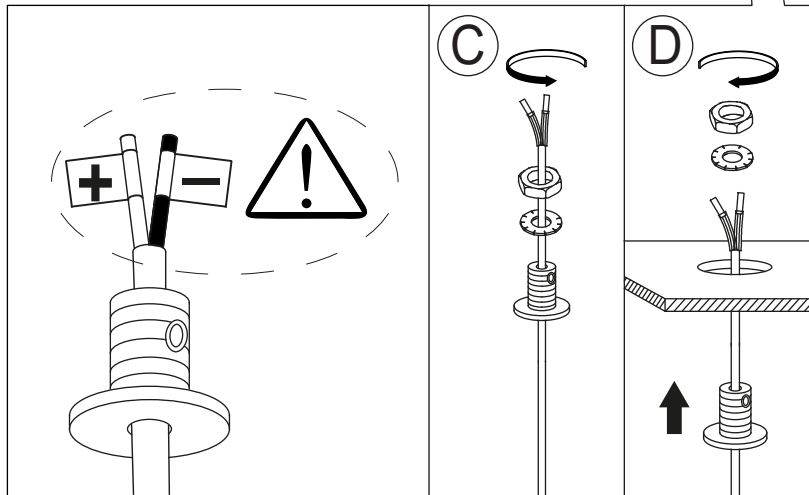
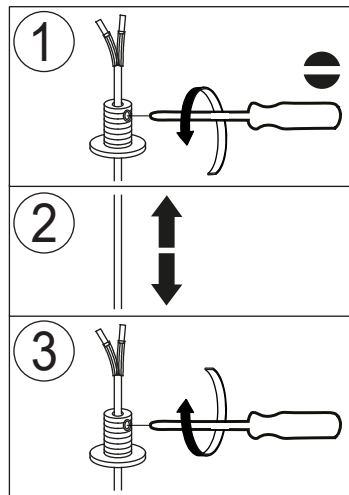
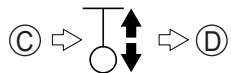
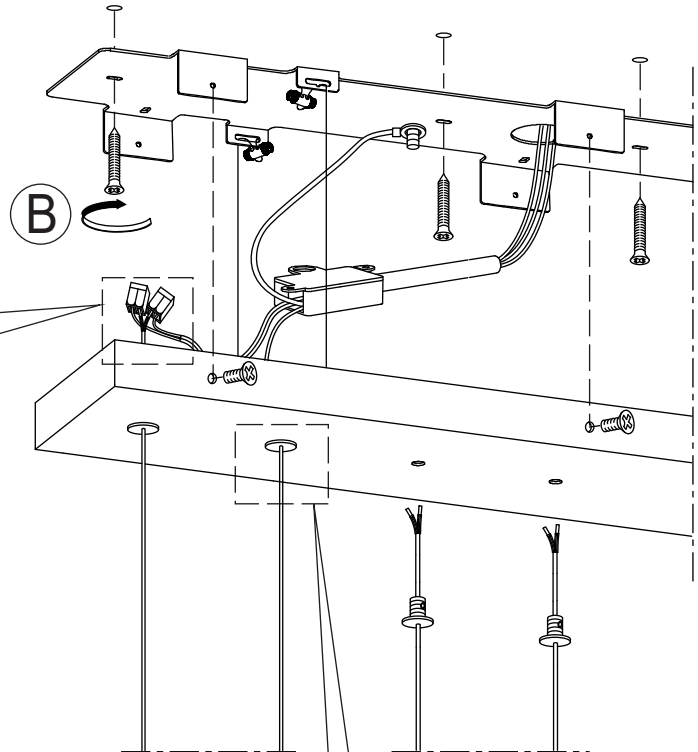
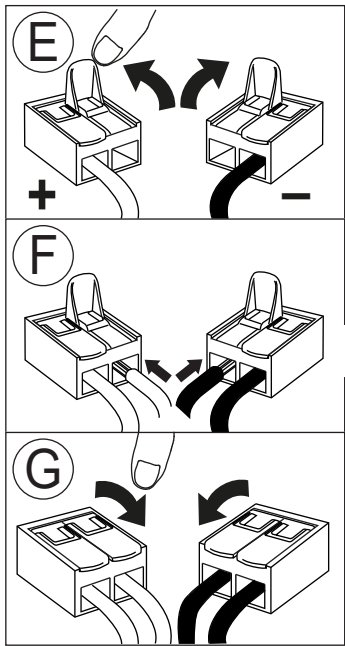
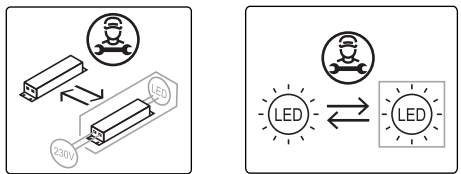
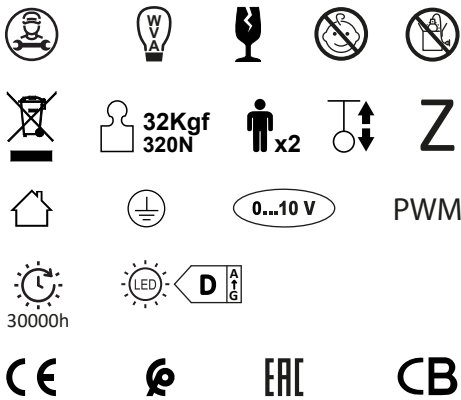



ABACUS

CODE 0V15S -- - FR4D

220-240V ~ 50/60Hz MAX 82,8W

12Vdc 7xMAX 3,6W

12Vdc 8xMAX 7,2W

integrated LED

3000K

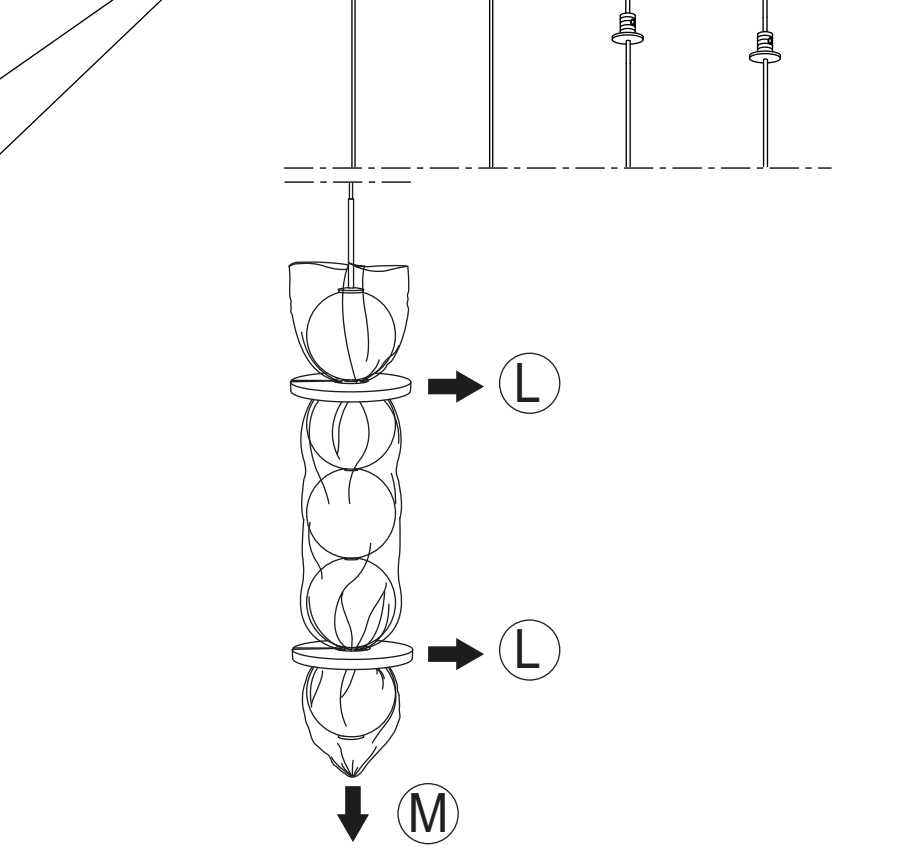
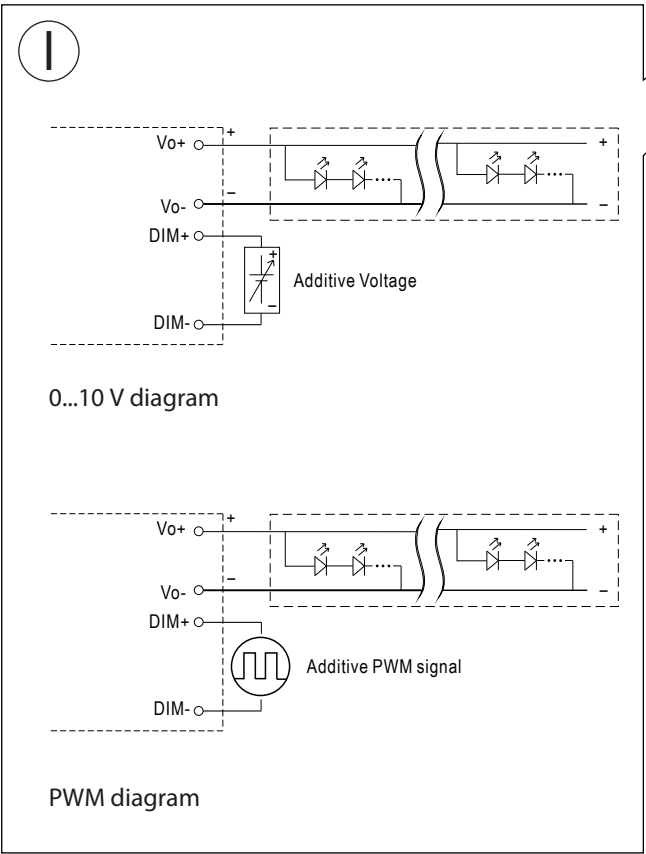
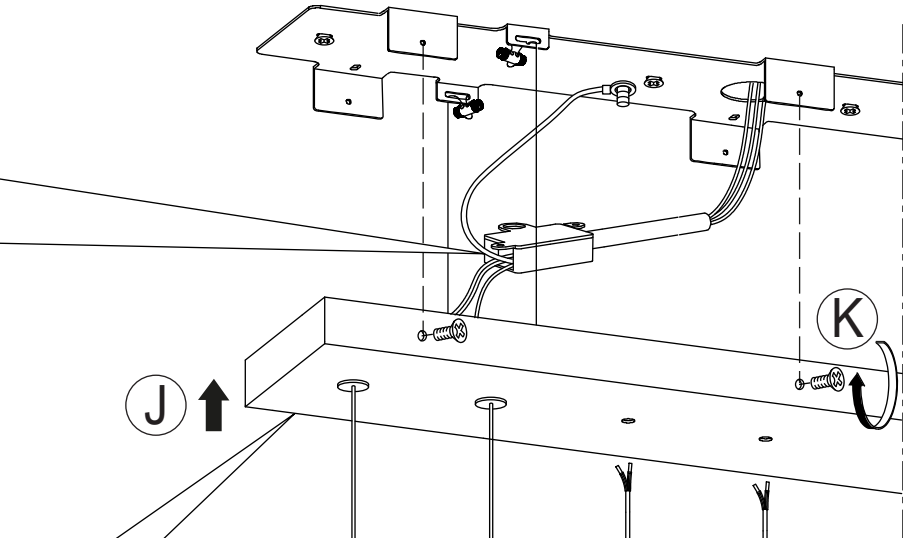
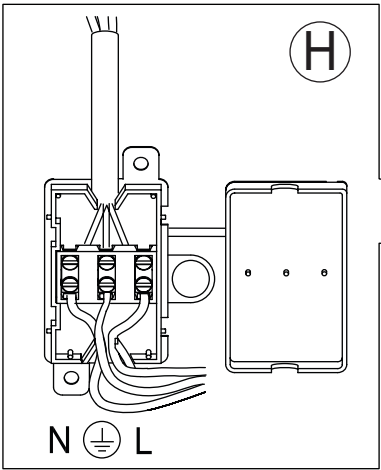
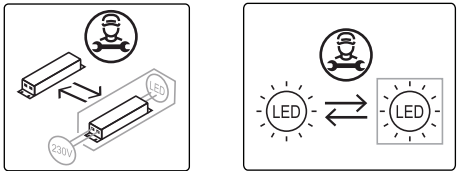
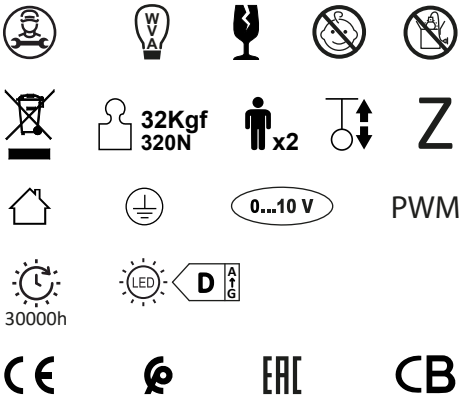

CLEANING INSTRUCTIONS

YES

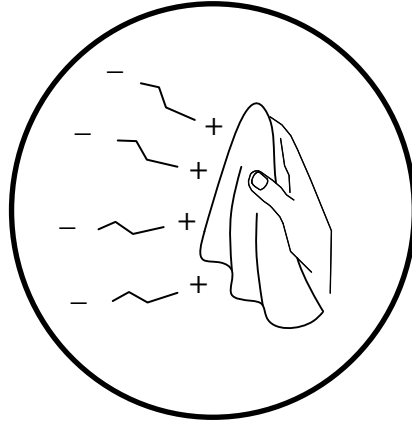

- IT** Usare panno elettrostatico asciutto
UK Use dry electrostatic cloth
FR Utiliser un chiffon électrostatique sec
DE Verwenden sie ein trockenes elektrostattuch
PY Использовать сухую электростатическую ткань
عربي استخدم قطعة قماش جافة كهرباء

NO

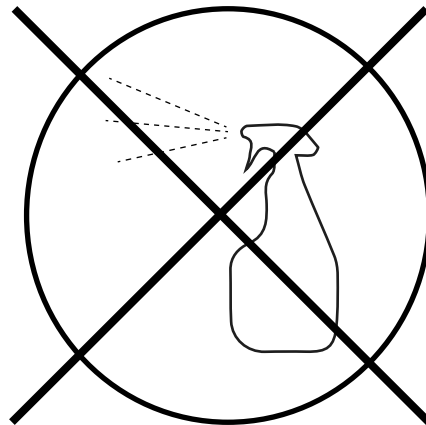

- IT** Non usare prodotti chimici | Usare prodotti specifici solo per cristalli e vetri
UK Do not use chemical products | Use specific products only for crystals and glass
FR Ne pas utiliser des produits chimiques | N'utiliser des produits spécifiques que pur les cristaux et le verre
DE Verwenden Sie keine Chemikalien | Verwenden Sie bitte nur Glas-bzw Kristallreiniger
PY Нельзя использовать химикаты | Использовать только специальные средства для хрусталя и стекла
عربي لا تستخدم المنتجات الكيماوية | استعمل مواد مخصصة للكريستال والزجاج فقط



IT Conservare questa istruzione per la manutenzione | **UK** Keep these instructions for maintenance
FR Garder ces instructions pour l'entretien | **DE** Dies Wartungsanleitung ist aufzubewahren
PY Сохраните эту инструкцию по эксплуатации | عربي احتفظ بهذه الإرشادات للصيانة

TERZANI
LA LUCE PENSATA

Abacus large linear multi light pendant
0V15S-FR4DD

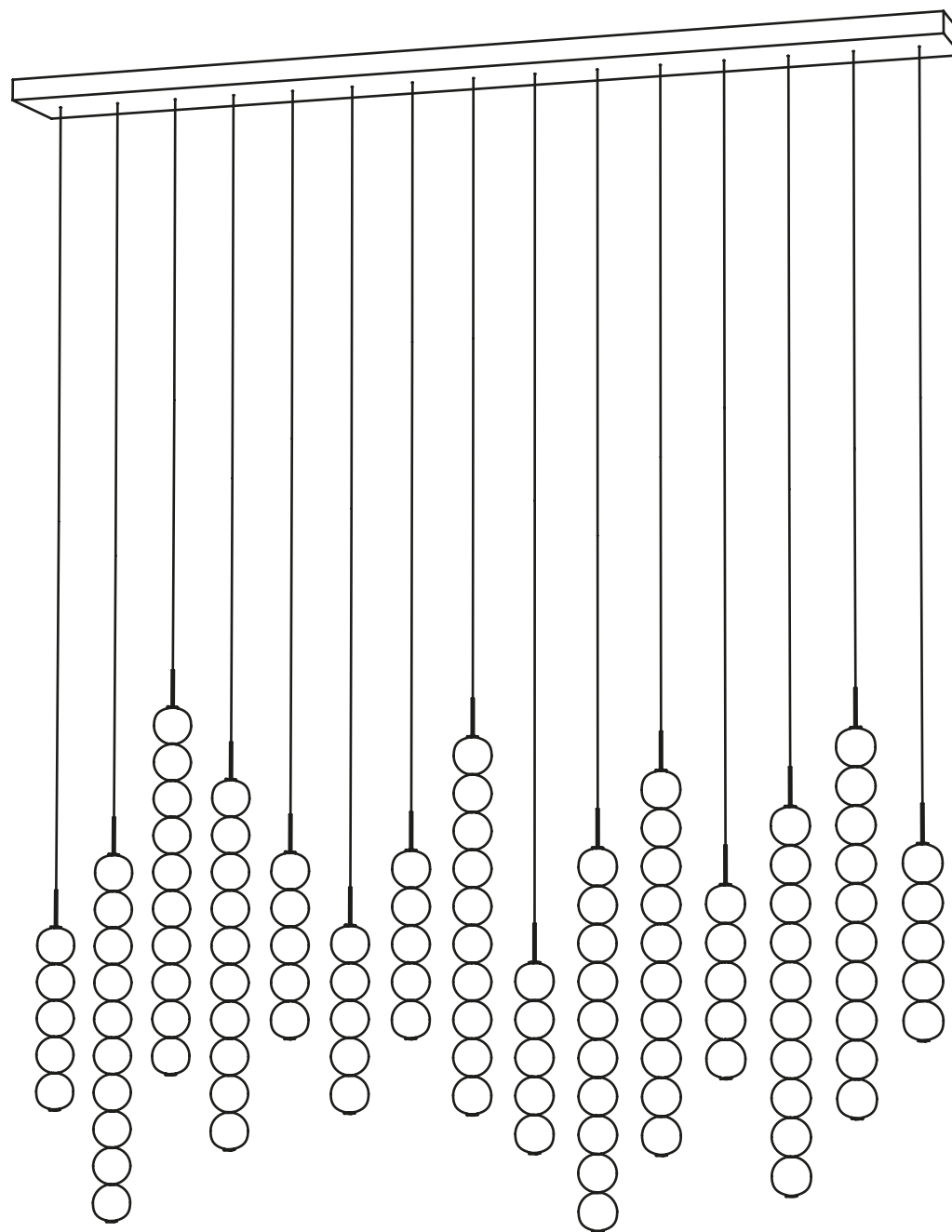



ABACUS

CODE 0V15S -- FR4DD

220-240V ~ 50/60Hz MAX 82,8W

12Vdc 7xMAX 3,6W

12Vdc 8xMAX 7,2W

integrated LED

3000K

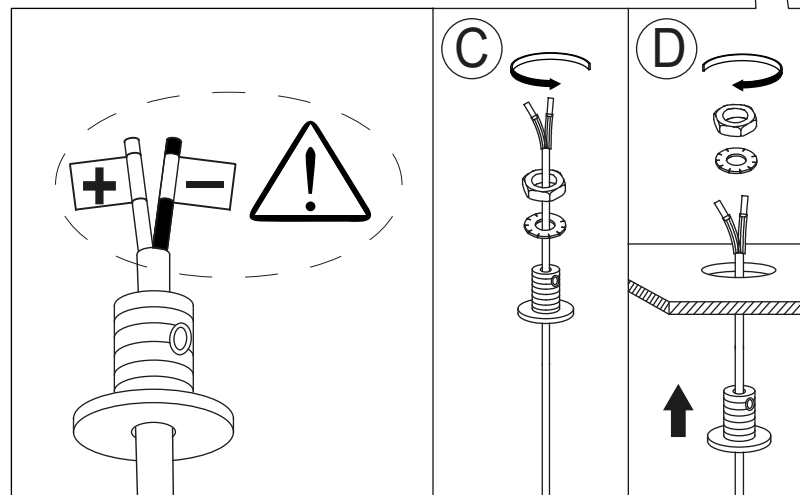
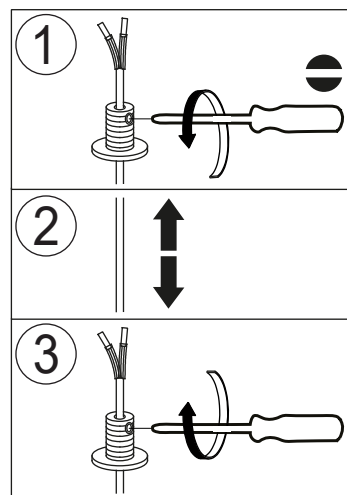
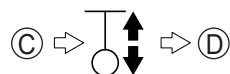
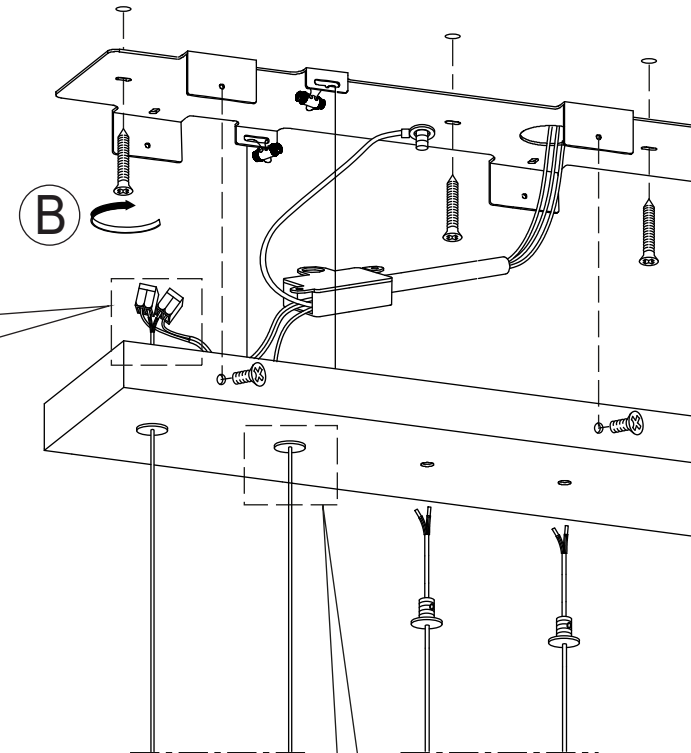
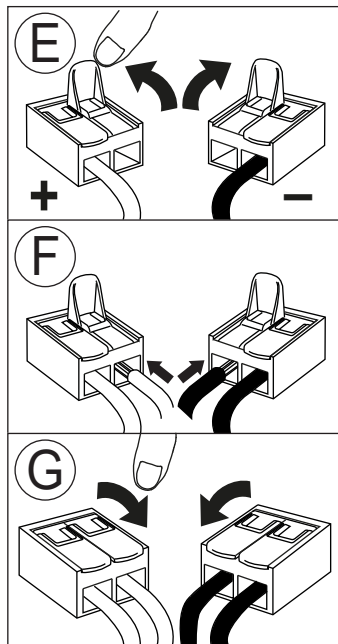
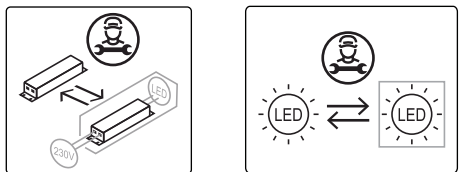

TERZANI
LA LUCE PENSATA

ABACUS

CODE 0V15S -- FR4DD

220-240V ~ 50/60Hz MAX 82,8W

12Vdc 7xMAX 3,6W

12Vdc 8xMAX 7,2W

integrated LED

3000K



32Kgf
320N



x2



Z



0/1...10 V

PUSH

100KΩ



30000h



D

A



ERC

CB

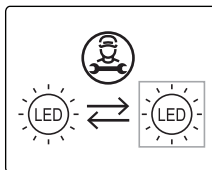
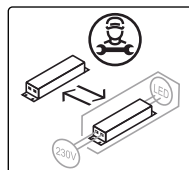

I

POTENTIOMETER MODE 100Kohm

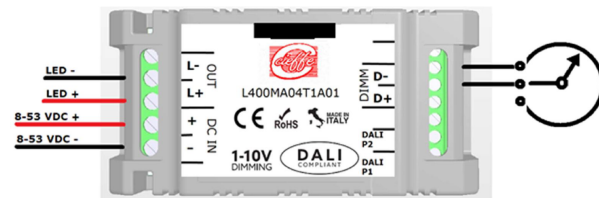

MODE 0-10V/1-10V PASSIVE

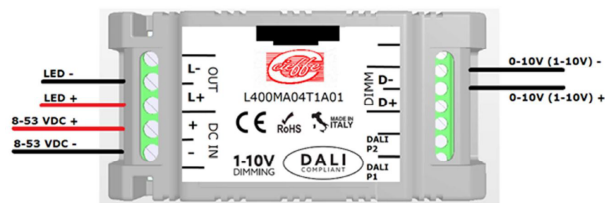

PUSH MODE

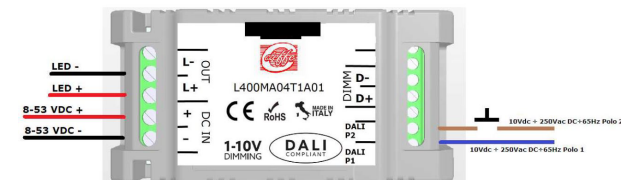

DALI MODE

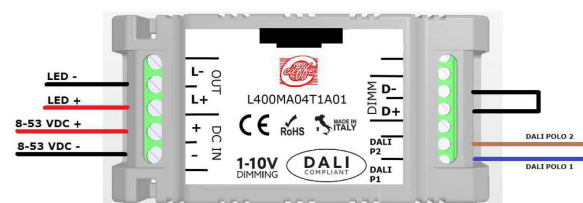

J

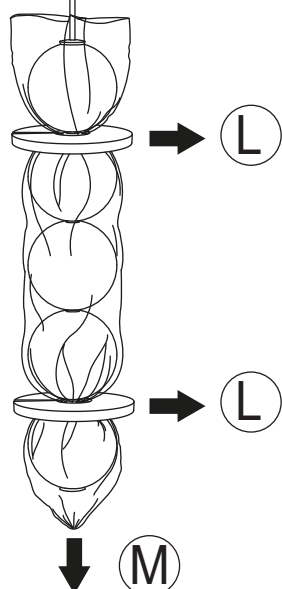
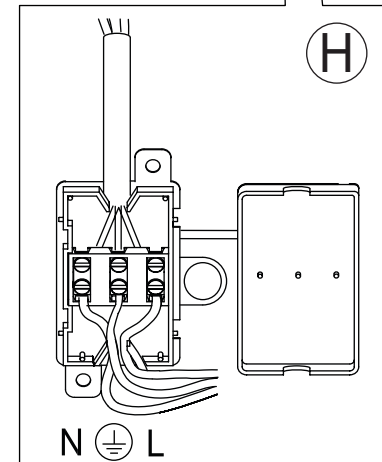
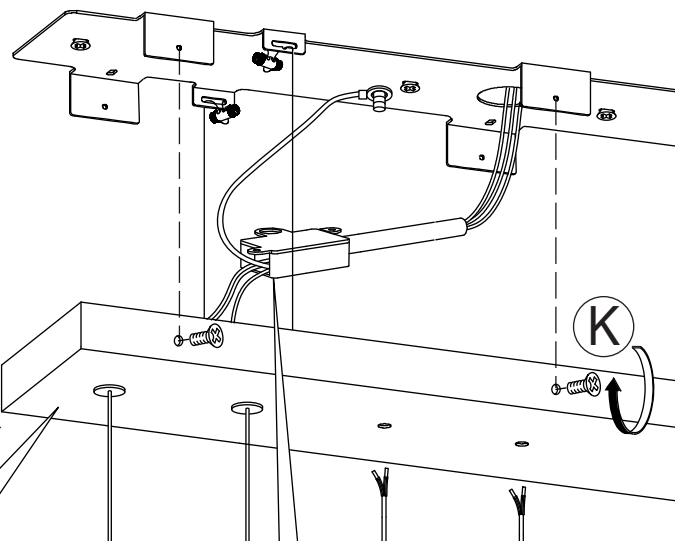

CLEANING INSTRUCTIONS

YES

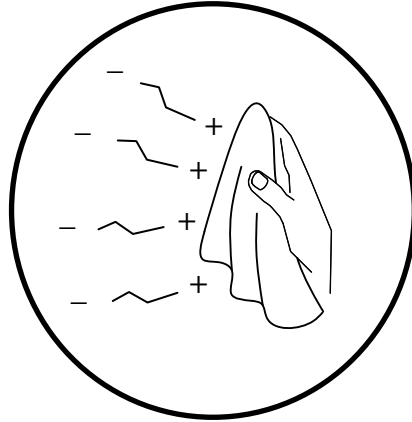

- IT** Usare panno elettrostatico asciutto
UK Use dry electrostatic cloth
FR Utiliser un chiffon électrostatique sec
DE Verwenden sie ein trockenes elektrostattuch
PY Использовать сухую электростатическую ткань
عربي استخدم قطعة قماش جافة كهرباء

NO

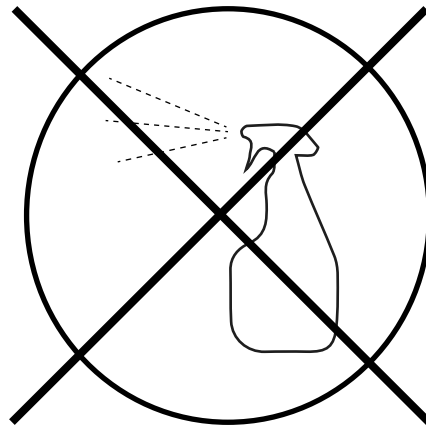

- IT** Non usare prodotti chimici | Usare prodotti specifici solo per cristalli e vetri
UK Do not use chemical products | Use specific products only for crystals and glass
FR Ne pas utiliser des produits chimiques | N'utiliser des produits spécifiques que pur les cristaux et le verre
DE Verwenden Sie keine Chemikalien | Verwenden Sie bitte nur Glas-bzw Kristallreiniger
PY Нельзя использовать химикаты | Использовать только специальные средства для хрусталя и стекла
عربي لا تستخدم المنتجات الكيماوية | استعمل مواد مخصصة للكريستال والزجاج فقط



IT Conservare questa istruzione per la manutenzione | **UK** Keep these instructions for maintenance
FR Garder ces instructions pour l'entretien | **DE** Dies Wartungsanleitung ist aufzubewahren
PY Сохраните эту инструкцию по эксплуатации | عربي احتفظ بهذه الإرشادات للصيانة