

**TERZANI**  
LA LUCE PENSATA

**Moiré** pendant light

**0M10S-F**

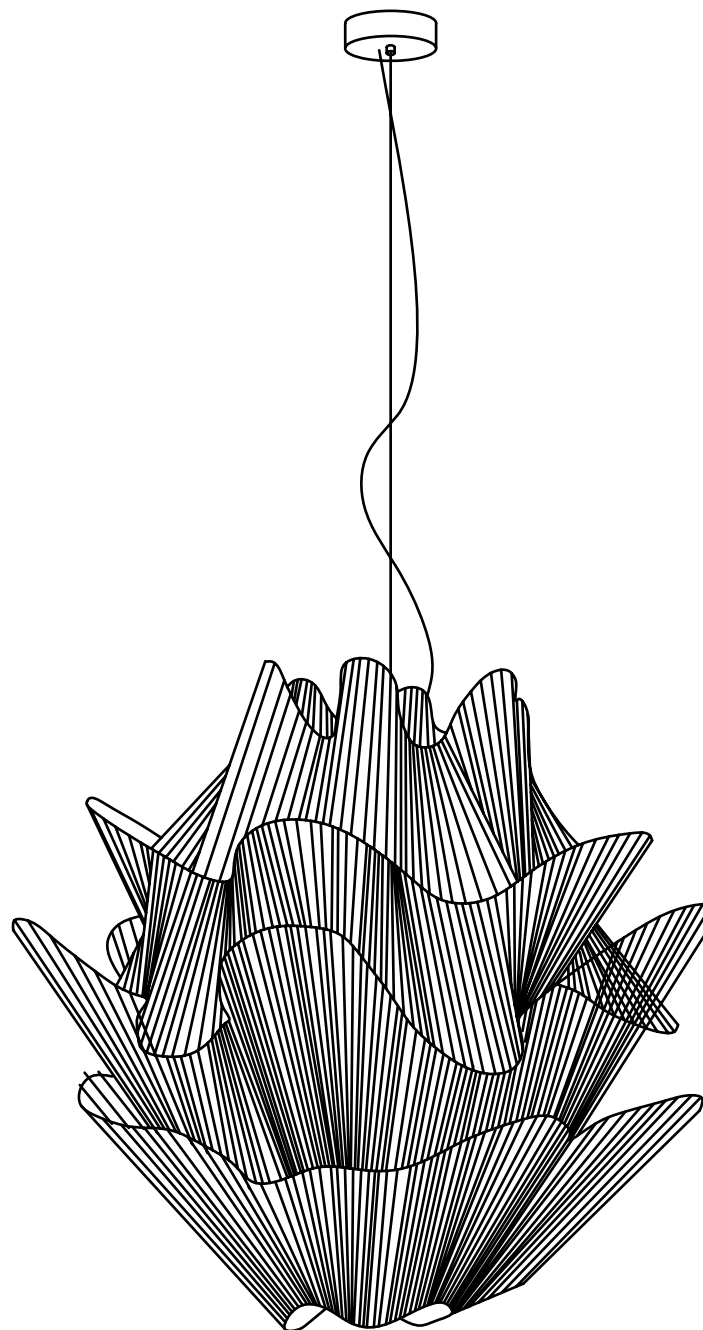

Design Christian Lava

MOIRÉ

CODE 0M10S -- F  
3000K

220-240V ~ 50/60Hz MAX 15,2W

700mA 1xMAX 15,2W

integrated LED



10,5Kgf  
105N

x2



1...10 V

PUSH



x 1,1m



30000h



F A G



ERC

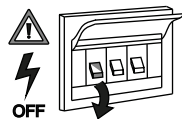
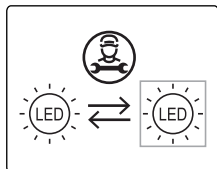
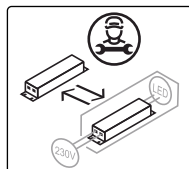

A

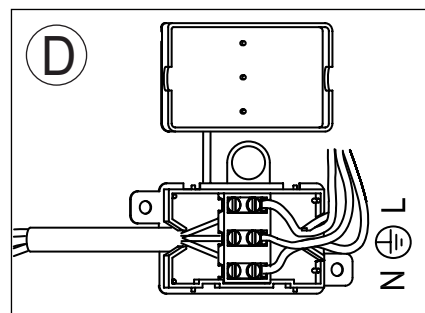

B  
x4

C  
x4

E

\* pag. 2/2

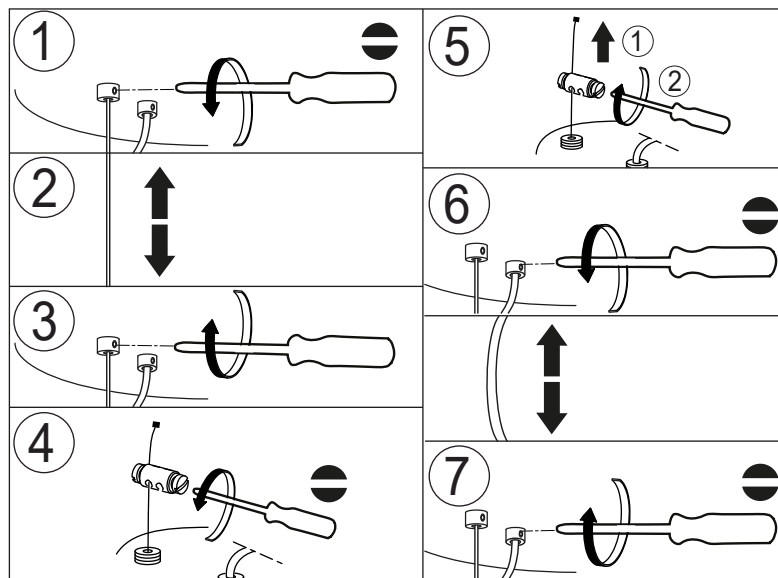
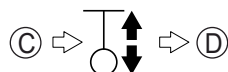



**MOIRÉ**

**CODE 0M10S -- F**  
**3000K**

**220-240V ~ 50/60Hz MAX 15,2W**

**700mA 1xMAX 15,2W**

**integrated LED**

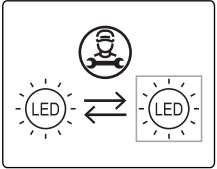
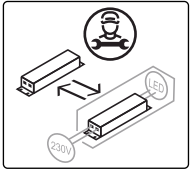

\*

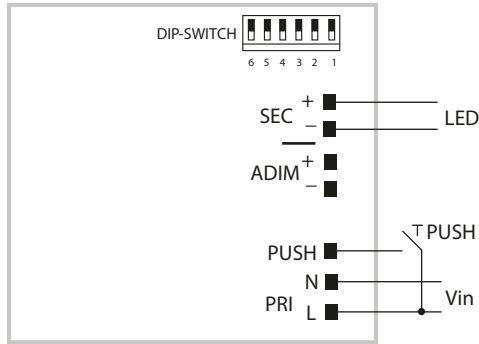

PUSH diagram

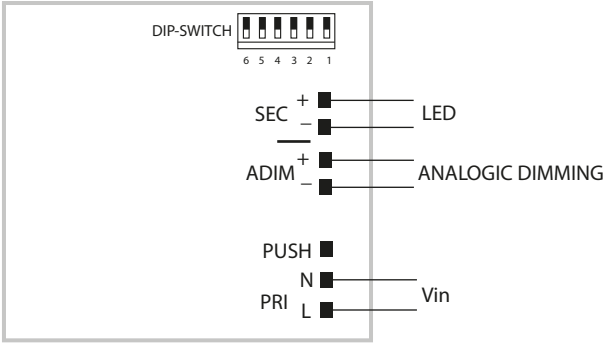

ADIM diagram

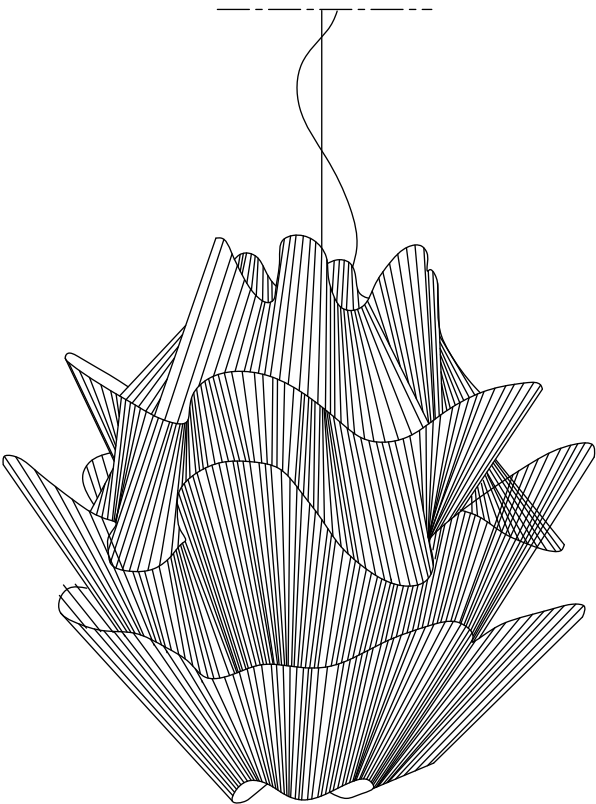

# CLEANING INSTRUCTIONS

## YES

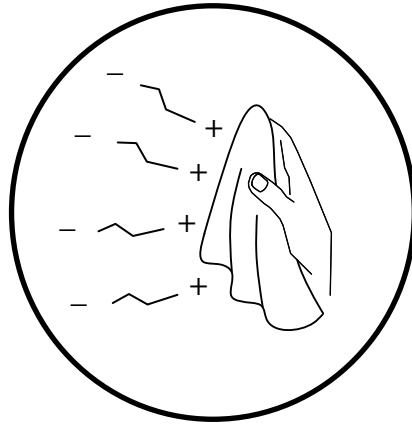

**IT** Usare panno elettrostatico asciutto

**UK** Use dry electrostatic cloth

**FR** Utiliser un chiffon électrostatique sec

**DE** Verwenden sie ein trockenes elektrostattuch

**PY** Использовать сухую электростатическую ткань

عربي استخدم قطعة قماش جافة كهرباء

## NO

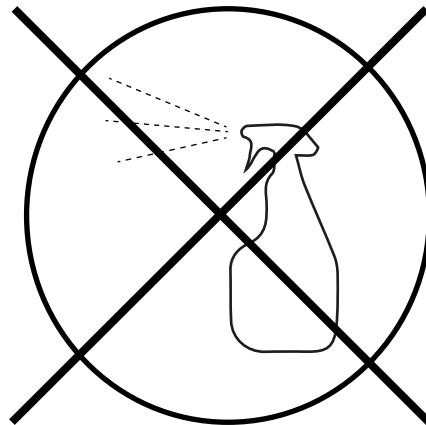

**IT** Non usare prodotti chimici

**UK** Do not use chemical products

**FR** Ne pas utiliser des produits chimiques

**DE** Verwenden Sie keine Chemikalien

**PY** Нельзя использовать химикаты

عربي لا تستخدم المنتجات الكيماوية



**IT** Conservare questa istruzione per la manutenzione | **UK** Keep these instructions for maintenance

**FR** Garder ces instructions pour l'entretien | **DE** Dies Wartungsanleitung ist aufzubewahren

**PY** Сохраните эту инструкцию по эксплуатации | عربي احتفظ بهذه الإرشادات للصيانة

**TERZANI**  
LA LUCE PENSATA

**Moiré** pendant light

**0M10S-FD**

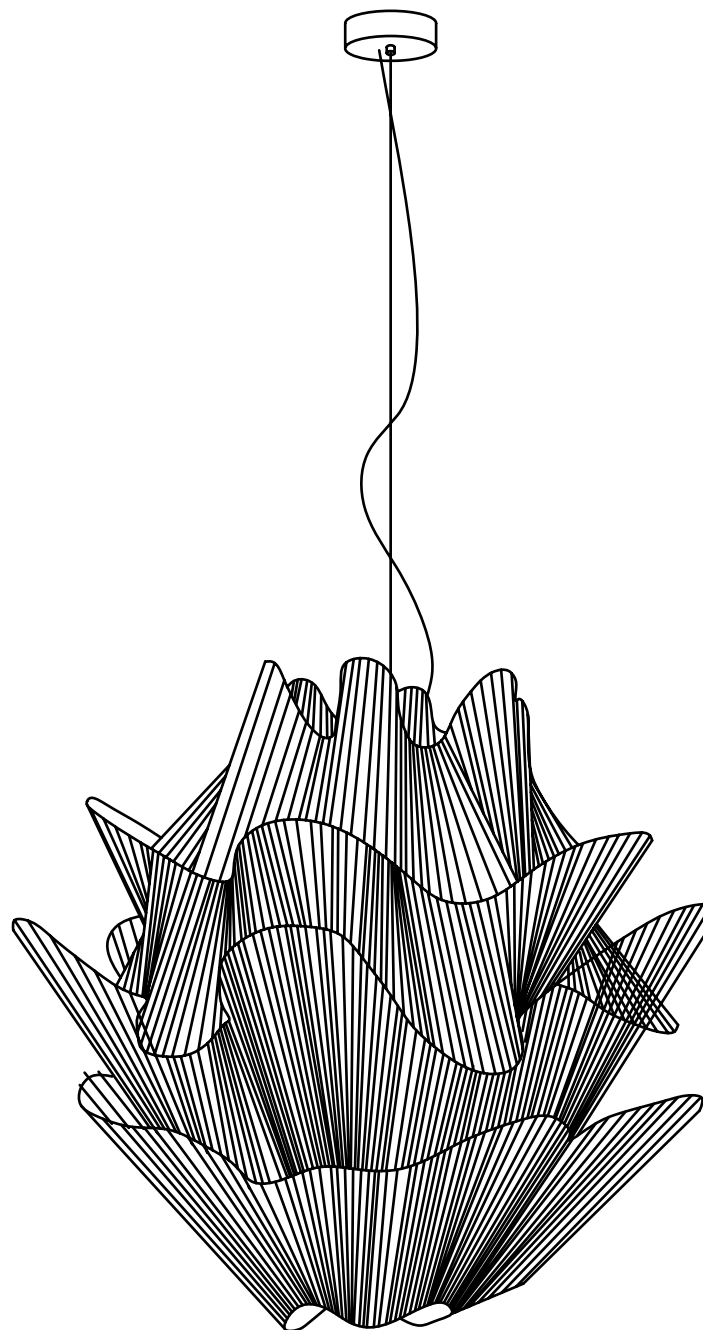

Design Christian Lava

MOIRÉ

CODE 0M10S -- -- FD  
3000K

220-240V ~ 50/60Hz MAX 15,2W

700mA 1xMAX 15,2W

integrated LED



10,5Kgf  
105N



x 1,1m



30000h



F A G

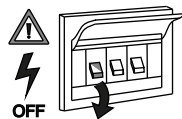
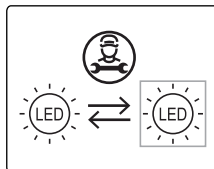
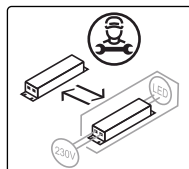

A

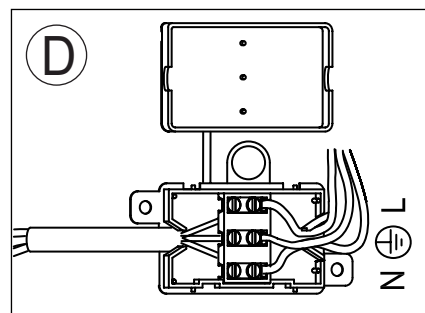

B  
x4

C  
x4

E

\* pag. 2/2

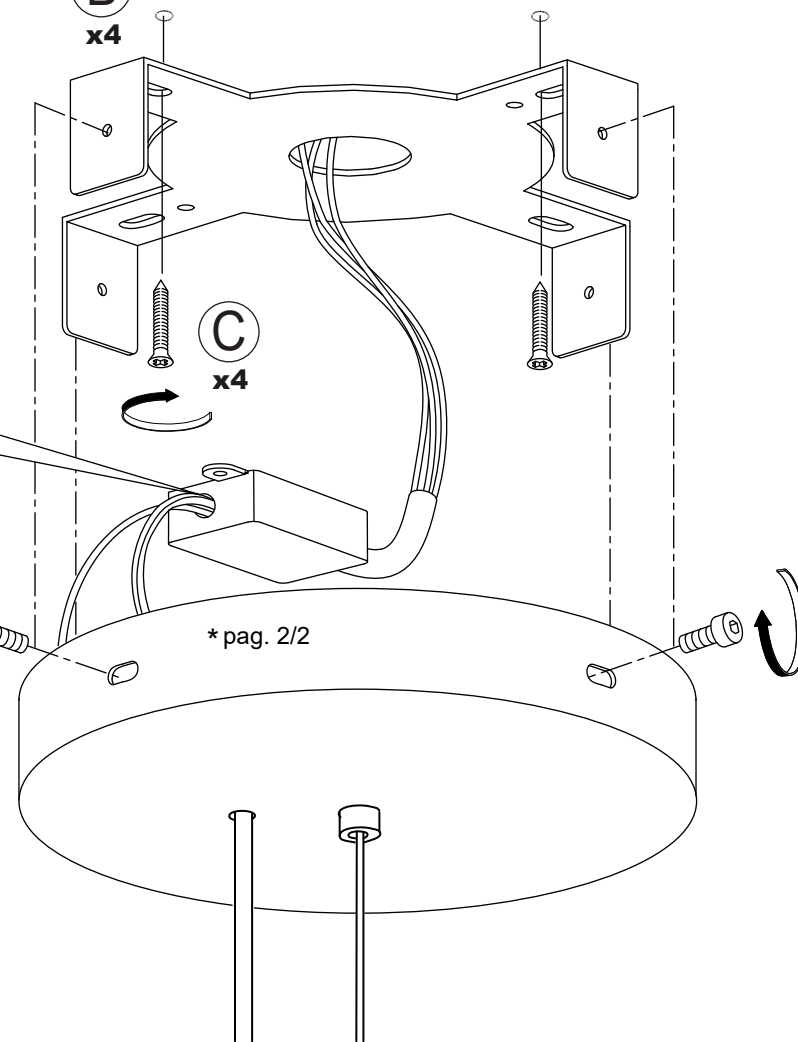
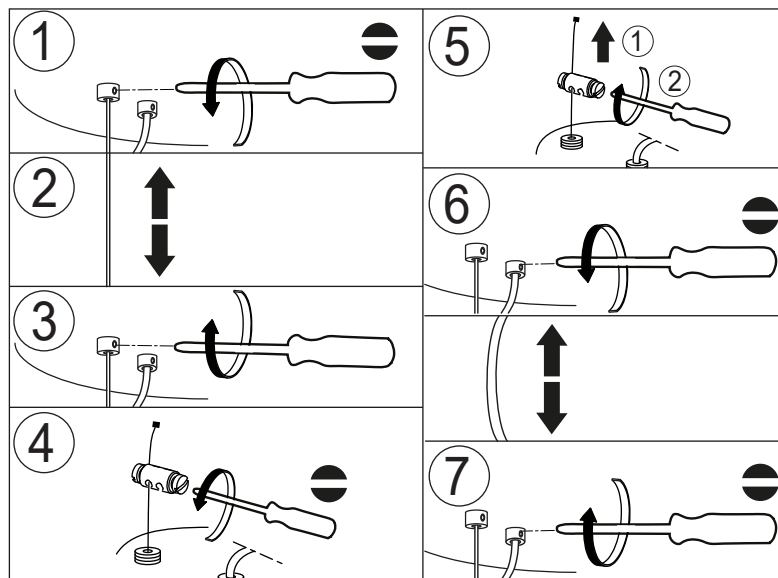
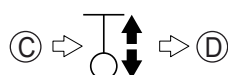



MOIRÉ

CODE 0M10S -- -- FD  
3000K

220-240V ~ 50/60Hz MAX 15,2W

700mA 1xMAX 15,2W

integrated LED

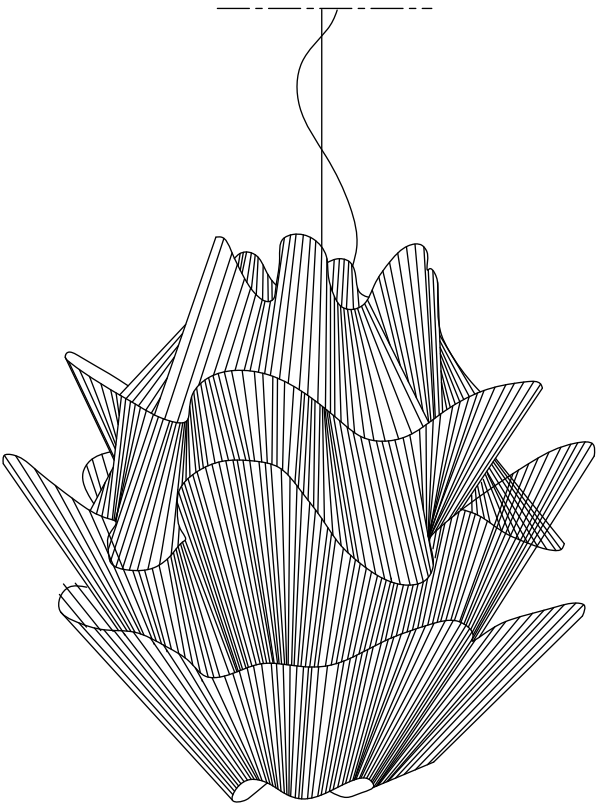
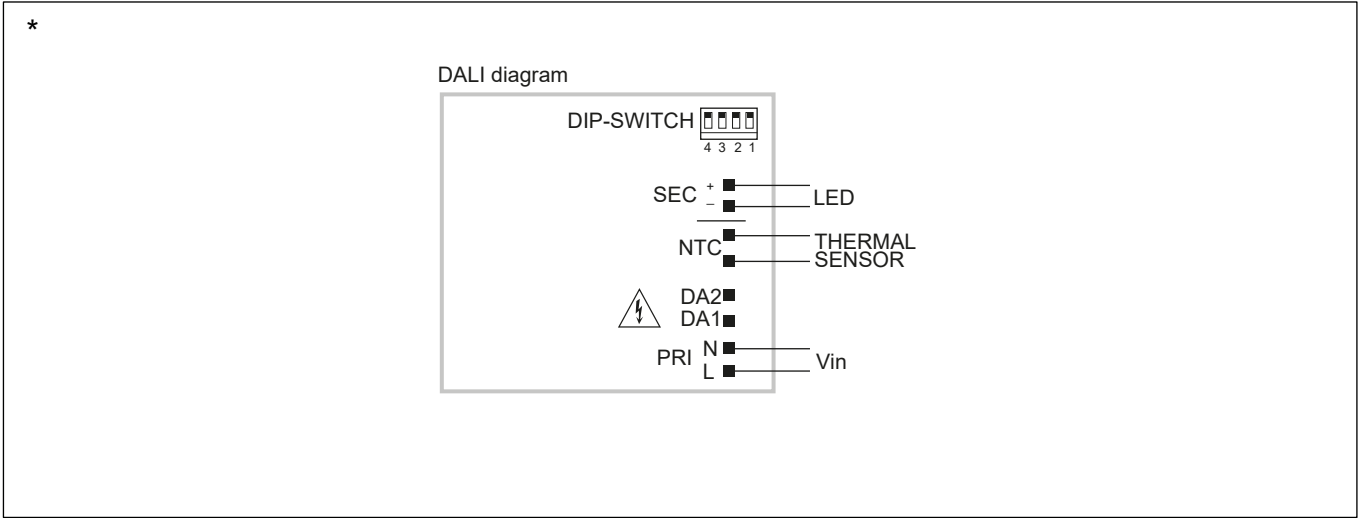
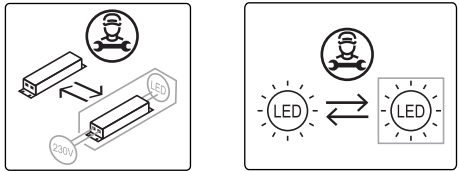

# CLEANING INSTRUCTIONS

## YES

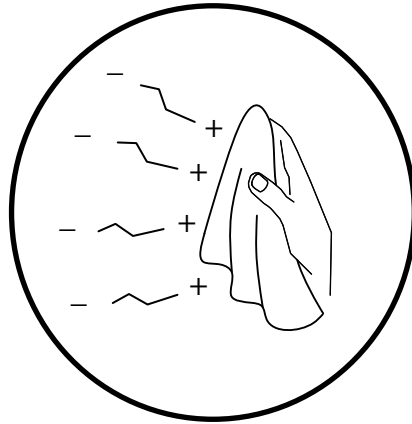

**IT** Usare panno elettrostatico asciutto

**UK** Use dry electrostatic cloth

**FR** Utiliser un chiffon électrostatique sec

**DE** Verwenden sie ein trockenes elektrostattuch

**PY** Использовать сухую электростатическую ткань

عربي استخدم قطعة قماش جافة كهرباء

## NO

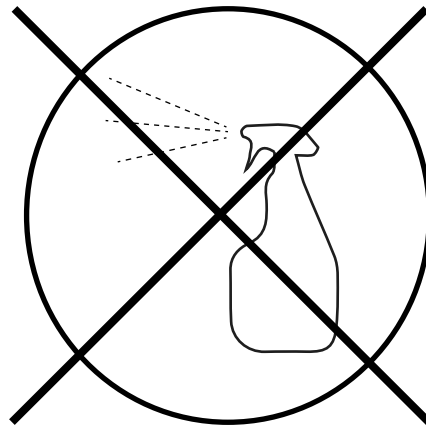

**IT** Non usare prodotti chimici

**UK** Do not use chemical products

**FR** Ne pas utiliser des produits chimiques

**DE** Verwenden Sie keine Chemikalien

**PY** Нельзя использовать химикаты

عربي لا تستخدم المنتجات الكيماوية



**IT** Conservare questa istruzione per la manutenzione | **UK** Keep these instructions for maintenance

**FR** Garder ces instructions pour l'entretien | **DE** Dies Wartungsanleitung ist aufzubewahren

**PY** Сохраните эту инструкцию по эксплуатации | عربي احتفظ بهذه الإرشادات للصيانة